



LUXURY CHALET RENTALS

ALPINE COLLECTION

CHRISTIANIA PENTHOUSE

Z E R M A T T



♦ Zermatt, Switzerland

♦ 538 m²

♦ Sleeps 14

♦ 7 bedrooms

♦ 6 bathrooms

♦ Sauna

♦ Shared access to gym

♦ Shared access to massage treatment room

♦ South facing balconies

♦ Dedicated cinema room

♦ Cable tv

♦ Wifi





THE RESIDENCE

Christiania Penthouse

Completed in 2017 and commanding an unrivalled position in the very heart of Zermatt, the Christiania Penthouse is among the resort's most exceptional addresses, sleeping fourteen guests across seven superbly appointed bedrooms set over two generous floors. Just five hundred metres from the Matterhorn Glacier Paradise and its direct access to the main ski area, the penthouse places both the slopes and the charming high street effortlessly within reach. Each bedroom has been conceived with complete comfort in mind, furnished with large super-king beds that may be configured as twins, alongside desks, televisions and private safes. Five bedrooms benefit from en-suite or private shower and bathroom facilities, whilst two may be closed off to form a self-contained family suite. The master bedroom is a particular triumph, offering breathtaking Matterhorn views, a wood-burning fireplace, a walk-in wardrobe, an en-suite bathroom and a generous private terrace.

Spanning some 538 square metres in total, the upper floor reveals an exceptionally spacious open-plan sitting and dining room of genuine elegance. Floor-to-ceiling sliding doors draw the eye directly to the iconic Matterhorn and flood the interior with alpine light throughout the day, opening onto a sun-drenched balcony perfectly suited to al-fresco relaxation. Come evening, sophisticated lighting and the glow of a second wood-burning fireplace create an atmosphere of warmth and conviviality. The principal dining table accommodates up to eighteen guests and may be extended to seat twenty-six, making the penthouse equally suited to intimate gatherings and grand celebrations. A well-equipped kitchen with a breakfast bar overlooks the picturesque town below, while a private sauna, a dedicated cinema room and a lift serving every floor of the property add further layers of refinement to daily life here.



Within the Christiania Residence building, residents enjoy shared access to a well-equipped gymnasium, a massage treatment room with shower area, and a ski room featuring private lockers and heated boot warmers for each apartment. The property may also be taken in conjunction with further apartments within the building, offering a seamlessly integrated solution for corporate retreats or larger private parties requiring combined dining for up to twenty-six. With prices ranging from CHF 10,980 to CHF 132,830 and a range of service levels available from accommodation-only through to fully catered, the Christiania Penthouse offers a bespoke and thoroughly considered alpine retreat at the very pinnacle of Zermatt living.













FLOORPLANS

TOP FLOOR



FLOORPLANS

THIRD FLOOR

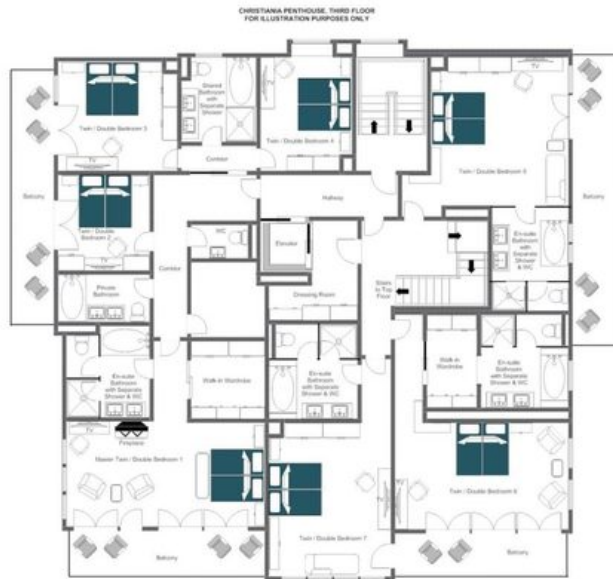



CHRISTIANIA PENTHOUSE



ZERMATT